

CHS Hall Walking Program MAP

FIRST FLOOR

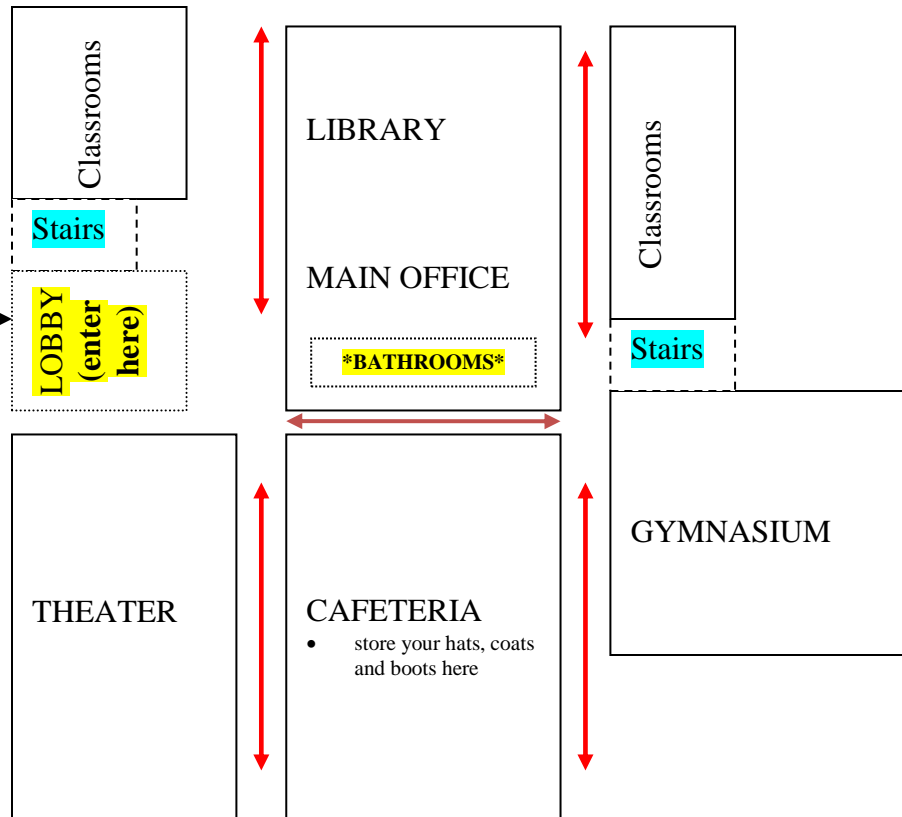

INFORMATION

Please follow the **CSD Hall Walking Guide** provided on the district website and the log-in binder located in the front lobby.

You may *hall walk indicated by the arrows*. You may also walk up and down *stairwells*.

Walking the downstairs “H” pattern of CHS 20 times is a ½ mile.
Walking the downstairs, upstairs and stair cases 7 times is a mile.

SECOND FLOOR

Offers a walking “loop”

